

HYDRODUCT[®] Vertical Drainage Sheets

Creep resistant geocomposite drainage sheets that provide highly efficient drainage to reduce hydrostatic pressure on basement walls

Description

HYDRODUCT[®] drainage sheets are pre-fabricated geocomposites comprising studded polystyrene drainage cores covered with polypropylene filter fabric. They provide efficient, cost effective alternatives to traditional aggregate drainage. HYDRODUCT[®] drainage sheets must link with either HYDRODUCT[®] Coil 150 or perforated sub-soil drains at the bottom of the basement wall, and carry to the site drainage system. This ensures water is drained away from the basement structure.

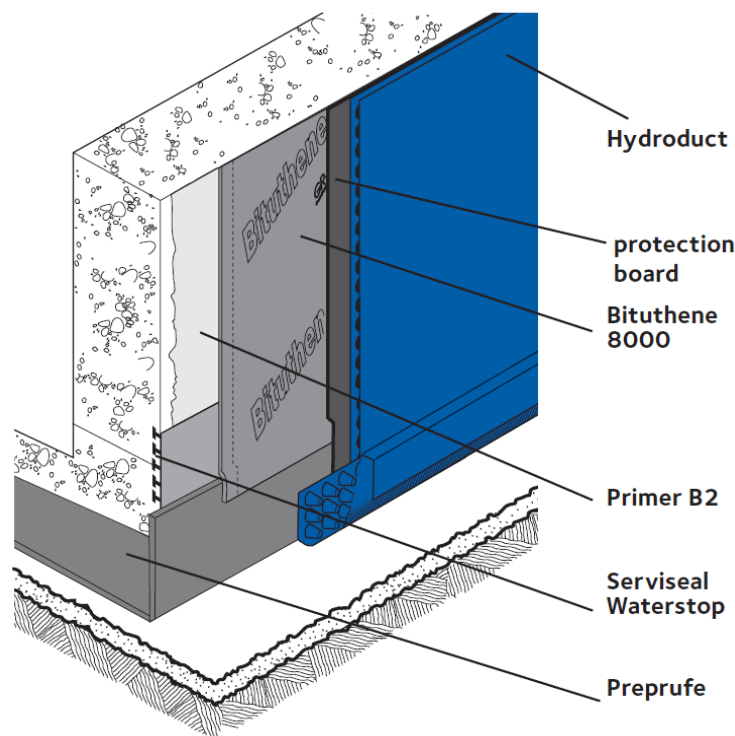

Details shown are typical illustrations only and not working drawings. For assistance with working drawings and additional technical advice please contact GCP Technical Services.

Advantages

- Polystyrene resists creep under long term loading – drainage capacity maintained
- High flow capacity – can drain 5.29 litres/sec/m when backfilled to a depth of 5 m
- Geotextile filter fabric prevents soil particles entering drainage core – minimises risk of clogging
- Rot proof – unaffected by immersion in water and resistant to dilute concentrations of chemicals
- No drainage aggregates needed – excavated soil re-used as backfill.

Product Range

HYDRODUCT® 200

Polypropylene non-woven filter fabric on one face of a 12 mm studded drainage core. Applied to walls of basements that have been waterproofed with BITUTHENE® membranes and SERVIPAK® protection boards.

HYDRODUCT® 220

Polypropylene non-woven filter fabric on one face of a 12 mm studded drainage core with a pressure dissipation plastic film bonded to the other face. Applied to walls of basements that have been waterproofed with BITUTHENE® membranes. Also applied to existing basement walls and permanent shuttering prior to the application of Preprufe membranes.

HYDRODUCT® Coil 150

Polypropylene non-woven filter fabric encapsulating a 26 mm studded drainage core. Installed at the bottom of basement walls and linked to the HYDRODUCT® sheet (as shown on drawing) an alternative to NBS Plus a perforated sub soil drainage pipe. Connectors must be used to join HYDRODUCT® Coil 150 to sub-soil drains (see drawing).

Applications

- As an alternative to traditional 'French' drains around the perimeter of basement structures
- With waterproofing membranes on walls of basement structures

Design

Designers are strongly advised to refer to British Standard 8102:2009, Protection of structures against water from the ground. Further guidance is available in CIRIA Report 139 'Water – resisting basements'. As almost all basement structures are likely to be subjected to water pressure at some stage BS 8102 encourages designers to consider the consequences of any leakage. Designers should therefore assess the risk of less than adequate workmanship when considering Type A (tanked) protection, especially where tanking is applied to masonry walls. The risk may be reduced by incorporating; subsoil drainage (where appropriate), into the design. to suit application.

Limitations

- Not suitable where 'Water table is anticipated to be permanently above the level of the sub – soil drain.
- Not recommended for masonry walls of basements in impermeable soils.
- When backfilling, compaction of backfill must be controlled to prevent displacement of HYDRODUCT® sheets.
- At temperatures below 0°C, additional fixings are necessary to secure the geotextile to the drainage core. Contact GCP for further details.

Supply

HYDRODUCT® 200/220	1.25 m x 32 m long roll x 12 mm thick (40 sq m) weight approx. 40 kg
Cut Fasteners	Strip 8 x 4 dimples, 5 supplied per roll
HYDRODUCT® Coil 150	150 mm deep x 26 mm thick x 30 m coils
Ancillary Materials	BITUSTIK® 4000 - 150 mm x 12 m rolls HYDRODUCT® Strip - 150 mm x 20 m rolls

For Fixing Directly to Substrate: Hammer drill with 6 mm diameter masonry drill. Hilti DX 36M cartridge gun and cartridge 6.8/1 IM calibre, Aerosmith pneumatic nailer, refer to manufacturer for type of fixing appropriate to substrate.

Core Properties 200/220

Core	Black moulded polystyrene
Compressive Strength	700 kN/m ²
Flow Capacity	5.29 litre/sec/m (i = 1 at 20 kPa)

Installation

Storage

Store under cover in original UV resistant polyethylene bags. If storage is to be for extended periods, store internally or in the shade.

Application against Protection Boards: HYDRODUCT®200 is recommended for this application. Fix horizontal strips of BITUSTIK® 4000 to the protection boards at approx. 600 mm centres. At temperatures below 10 °C, warm the BITUSTIK® gently with a hot air gun before application to improve the adhesion. Alternatively use adhesive 'spike' fixings that can be bonded to the protection board without penetrating the waterproofing membrane. Apply the HYDRODUCT®200, geotextile facing outwards and bond to the BITUSTIK®. Where possible, secure the HYDRODUCT® in place at the top of the wall, but do not penetrate the waterproofing membrane with any fixings.

The filter fabric is bonded to the core with pressure sensitive glue which permits the fabric to be peeled back to form overlaps etc. The glue can be softened if required using a hot air gun. Do not use an open flame since this will damage the fabric. The geotextile filter fabric is always laid towards the water face to allow water entry. The sheets can be joined horizontally and vertically by overlapping the geotextile fabric 100 mm and butt jointing the studded cores. Cut Fasteners are then used to form a connector at centres to suit application by interlocking a minimum of two dimples by eight dimples long on each sheet and reinstating the fabric to form a weathered lap.

Corners

HYDRODUCT®200 can be bent on site to form internal corners. External corners are formed by cutting the geotextile and providing an additional 100 mm wide strip of geotextile to wrap around corner to prevent infiltration of soil at the overlap joint.

Installation with HYDRODUCT® coil

Peel back geotextile fabric from studded core. Place HYDRODUCT®Coil 150 against core, wrap with filter fabric and tuck behind core. Place a small amount of aggregate on fabric to hold in place prior to backfilling.

Sealing edges

All exposed edges of HYDRODUCT® should have filter fabric tucked behind core to seal leading edge to prevent soil from entering the core.

Weep holes

If weep holes are required in retaining walls 12-15 mm diameter holes should be carefully cut through studded sheet opposite holes leaving the geotextile fabric intact.

On high walls it may be necessary to decrease the fixing centres or lay HYDRODUCT® sheets horizontally in stages and backfill progressively to prevent slumping.

Application directly against BITUTHENE® Membranes

HYDRODUCT®220 is recommended for this application. The black plastic film should be applied against the membrane with the geotextile fabric facing outwards. Install as per application against SERVIPAK® Protection Boards.

Application directly to adjacent basement walls or permanent shuttering

Fix directly to the substrate using masonry nails, shot fired or pneumatic fixings at centres sufficient to retain the drainage sheet securely in place.

Basement Drainage Collector

HYDRODUCT®Coil 150 should be used around the perimeter base of tanked basement retaining walls, contiguous and piled walls including landscape walling to collect and control ground water. It is a cost effective method of providing site drainage in confined spaces which can be linked to the overall drainage system. It should be used in conjunction with HYDRODUCT® sheets placed against waterproof membrane systems to form an integrated drainage system.

HYDRODUCT®Coil 150 should be placed at the bottom of the basement wall and joined with the site drainage system using the preformed connectors.

Corners

HYDRODUCT®Coil can be bent or cut to form a mitre and covered with GCP HYDRODUCT®Strip to prevent fines and silt from entering the core.

Connectors

The HYDRODUCT®Coil is cut to length using a Stanley knife and inserted into the connector and held in place with GCP HYDRODUCT®Strip.

Health and Safety

There is no legal requirement for a Safety Data Sheet for the HYDRODUCT® range of products. For health and safety questions on these products please contact GCP Applied Technologies.



Grace Construction Products Ltd
Ipswich Road, Slough, Berkshire SL1 4EQ
United Kingdom
12 CPD-44

0799

EN 13252:2000 + A1:2005
HYDRODUCT® 200 & HYDRODUCT® 220 Geotextile for filtration, separation and drainage (F+S+D) in drainage systems, Type F+S+D

gcpat.ae | United Arab Emirates customer service: +971 4 5139560

We hope the information here will be helpful. It is based on data and knowledge considered to be true and accurate, and is offered for consideration, investigation and verification by the user, but we do not warrant the results to be obtained. Please read all statements, recommendations, and suggestions in conjunction with our conditions of sale, which apply to all goods supplied by us. No statement, recommendation, or suggestion is intended for any use that would infringe any patent, copyright, or other third party right.

BITUTHENE, BITUSTIK, and HYDRODUCT are trademarks, which may be registered in the United States and/or other countries, of GCP Applied Technologies Inc. This trademark list has been compiled using available published information as of the publication date and may not accurately reflect current trademark ownership or status.

© Copyright 2018 GCP Applied Technologies Inc. All rights reserved.

GCP Applied Technologies Inc., 2325 Lakeview Parkway, Alpharetta, GA 30009, USA

P. O. Box 5006, Office 2104, 21 Floor, The Exchange Tower, Opp. JW Marriott Marquis Hotel, Business Bay, Dubai – United Arab Emirates

This document is only current as of the last updated date stated below and is valid only for use in the UAE. It is important that you always refer to the currently available information at the URL below to provide the most current product information at the time of use. Additional literature such as Contractor Manuals, Technical Bulletins, Detail Drawings and detailing recommendations and other relevant documents are also available on www.gcpat.ae. Information found on other websites must not be relied upon, as they may not be up-to-date or applicable to the conditions in your location and we do not accept any responsibility for their content. If there are any conflicts or if you need more information, please contact GCP Customer Service.

Last Updated: 2022-11-18

gcpat.ae/solutions/products/hydroduct-vertical-drainage-sheets